

## TECHNICAL SPECIFICATIONS

### SPECIFICATIONS Eicher Pro 5025T

GVW	25000 kgs.		Suspension Rear	Bogie Suspension	Bell Crank Suspension (Optional)
Max. Power	180 hp @ 2500 rpm		Steering	Hydraulic Power Steering	
Max. Torque	685 Nm @ 1500 rpm		Gradeability	43%	
Clutch Type	Coil spring push type		Max. Speed	70 kmph	
Clutch Dia.	380 mm		Fuel Tank	220 L	
Gear Box	ZF 1110TD (8 Forward, 1 Crawler & 1 Reverse)	ET 80 (6 Forward & 1 Reverse) (Optional)	Electrical System	24 V	
Gear Ratio	1st (Crawler): 12.73, Reverse: 12.04	1st : 9.26, Reverse: 8.02 (Optional)	Battery	150 Amp.	
Rear Axle	Meritor Axle		Tyre Size	Front - Std. 10x20-16PR (Rib Pattern) Rear & Spare - Std. 10x20-16PR (Lug Pattern)	
Rear Axle Ratio	6.833		Wheel Rim Size	7.5x20	
Front Axle	Reverse Elliot type I Beam		TCD	15.8 m	
Chassis Type	Rolled C-Channel Straight Frame, 285x76x7 mm		Ground Clearance	252 mm	
Service Brakes	Dual circuit, full S-cam Air		Wheelbase	4000 mm	
Suspension Front	Semi-elliptical leaf spring w/o Anti-roll Bar		Body Size & Type	16 Cum. Box Type	14 Cum. Box Type (Optional)

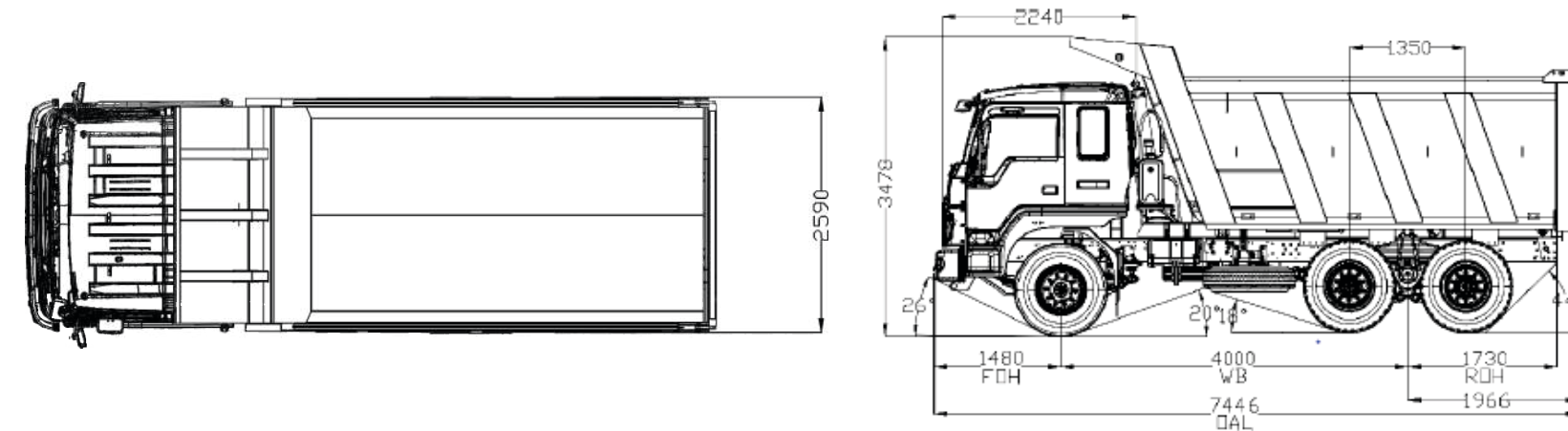

The above layout is with 16 CuM Box body

#### EICHER TRUCKS AND BUSES

VE Commercial Vehicle Ltd.  
(A Volvo Group and Eicher Motors joint venture)  
#96, Institutions Area, 3rd Floor Sector 32,  
Gurgaon-Haryana-122001, India.  
Phone: +91 124-4415600



Authorised Distributor

Eicher **Pro** 5025T  
The 25 Ton GVW Tipper

TRUCKS AND BUSES

**MOVE AHEAD!**  
with Eicher Pro 5025T-Built Tougher, Lasts Longer



**EICHER** GO PRO

## PARTNERSHIP WITH THE VOLVO GROUP

Two leading players in the commercial vehicle business joined hands in 2008 with a convergent vision of driving modernization in commercial transportation. Volvo Group, the world's leading manufacturer of trucks, buses, construction equipment and marine & industrial engines, brought its global expertise and world-class technology, while Eicher Motors brought its frugal engineering and deep knowledge of the developing markets.

The mission of this joint venture- VE Commercial Vehicles Ltd, is raising the standard of the commercial transportation industry and taking it to a new professional level.



Leader in commercial transportation

Frugal engineering and operation

Aftersales infrastructure

Cost-effective operations



VOLVO GROUP

Global expertise

Leadership in product technology

Well-defined processes and controls

Brand image



### GLOBAL TECHNOLOGY MEETS FRUGAL ENGINEERING

The completely new chassis and assembly line have been built to balance high technology with frugal engineering. The state-of-the-art manufacturing process which includes a robotic cab weld shop, CED paint shop and 100% hot test facility, ensures quality and reliability of international standards.

### GLOBAL STANDARD MANUFACTURING PLANT

The Eicher Pro series has been designed and developed in a modern and high-tech manufacturing facility in Pithampur, near Indore.

The next-generation engine plant, built in collaboration with the Volvo Group, not only manufactures Euro III and IV heavy-duty engines but also supplies Euro VI engines internationally to the Volvo Group.

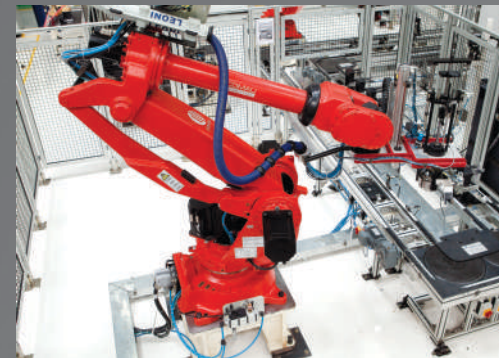

## KEY FEATURES



- Modern and spacious cabin with state-of-the-art features
- 6-way adjustable driver seat for comfortable drives
- CED painted cabin with high-gloss life
- Fans in cabin for driver and co-driver comfort
- Dual footstep with grab handle for easy climbing
- Refreshed dashboard with lockable and open storage spaces and 3 din system
- Tilt and telescopic power steering



Instrument cluster with LCD display

## OTHER FEATURES

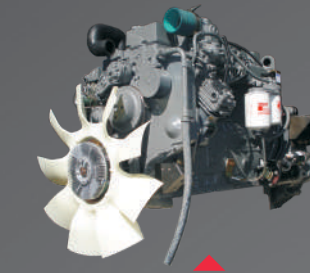

- World-class Cummins engine with 180 hp & 685 Nm torque
- Enhanced reliability
- Better pick-up & faster turnaround time

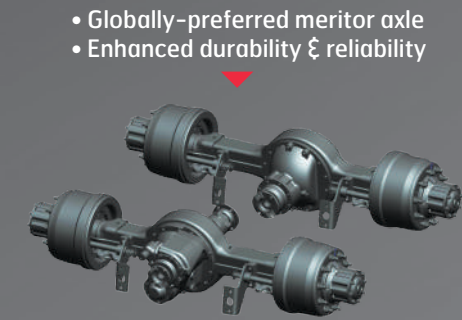

- Globally-preferred meritor axle
- Enhanced durability & reliability

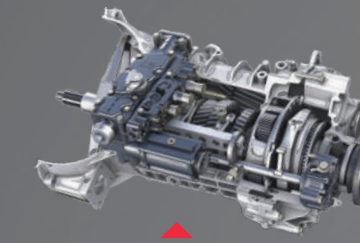

- ZF 9-Speed gearbox
- Higher durability



- Heavy-duty bogie suspension
- Enhanced suspension life with 11 leaves

## EICHER PRO 5000 SERIES

Eicher Pro 5000 series is a new range of highly durable and reliable BSIII trucks from 16T to 40T GVW which cater to the needs of the growing commercial vehicle industry across different segments. These trucks are designed to deliver best-in-class fuel efficiency and optimised operational cost, leading to quick returns on investment.



**Toughest & Robust Aggregates**



**Enhanced Reliability & Durability**



**Enhanced Driver Efficiency**



**Best-in-class Fuel Efficiency**

Move ahead in your trucking business with Eicher Pro 5025T having toughest & robust aggregates backed by Volvo group's expertise, Eicher offers competitive fuel efficiency and a contemporary cabin for superior ride comfort to boost driver's efficiency. Move ahead with Eicher, Move ahead for more.

